



UK Analytical Ltd
Unit F1
Copley Hill Trading Estate
Whitehall Road
Leeds
LS12 1HE

Telephone: 0113 245 6303
Email: enquiries@ukanalytical.com
Web: www.ukanalytical.com

Report no: 22/22869

Date: 22 November 2022

Client: Adept Consulting Engineers Ltd.

Location: Rose Garden Café, Sheffield
Outbuilding to Rear
Concrete Testing

J M Noone BSc, Managing Director
R W Brown, Director

Registered Office: Endon House, 127 Barugh Lane, Barugh Green, Barnsley S75 1LJ
Registered in England. No: 9910400.
VAT Registered No: 230 3579 28



Report no: 22/22869

Date: 22 November 2022

Client: Adept Consulting Engineers Ltd.

Location: Rose Garden Café, Sheffield
Outbuilding to Rear
Concrete Testing

Introduction:

The above site is an older stone building with a smaller concrete outbuilding housing the kitchen and store rooms to the rear,

The purpose of this report is to determine the nature of the concrete on the underside of the roof slabs.

Methods:

1. Covermeter Survey

Covermeter testing was attempted to be carried out to the underside of the ceiling in 3 locations and to the underside of the roof slab in the location A. The locations of the test areas are shown in Appendix 1.

No breaking out to confirm bar diameters was allowed so the values quoted are approximate.

Drawings of the reinforcement details are shown in Appendix 2.

Photographs of the areas are shown in Appendix 3.



Report no: 22/22869

Date: 22 November 2022

Client: Adept Consulting Engineers Ltd.

Location: Rose Garden Café, Sheffield
Outbuilding to Rear
Concrete Testing

Comments:

The following comments are made:

- The roof of the main area of the building is wood with bitumen covering to the top.
- The wood/bitumen roof is approximately 40mm in depth with a 210mm void directly below.
- The concrete roof on the lower outbuilding is approximately 170mm in depth with 2 layers of lower bars detected.

J M Noone Director



Page 2 of 2

J M Noone BSc, Managing Director
R W Brown, Director

Registered Office: Endon House, 127 Barugh Lane, Barugh Green, Barnsley S75 1LJ
Registered in England. No: 9910400.
VAT Registered No: 230 3579 28



UK Analytical Ltd
Unit F1
Copley Hill Trading Estate
Whitehall Road
Leeds
LS12 1HE
Telephone: 0113 245 6303
Email: enquiries@ukanalytical.com
Web: www.ukanalytical.com

Report no: 22/22869

Date: 22 November 2022

Client: Adept Consulting Engineers Ltd.

Location: Rose Garden Café, Sheffield
Outbuilding to Rear
Concrete Testing

Appendix 1

Sample Test Areas

J M Noone BSc, Managing Director
R W Brown, Director

Registered Office: Endon House, 127 Barugh Lane, Barugh Green, Barnsley S75 1LJ
Registered in England. No: 9910400.
VAT Registered No: 230 3579 28

JOB No: 12869

ROSE GARDEN CAFE - SHEFFIELD

DATE: 15/11/22

ROOF PLAN

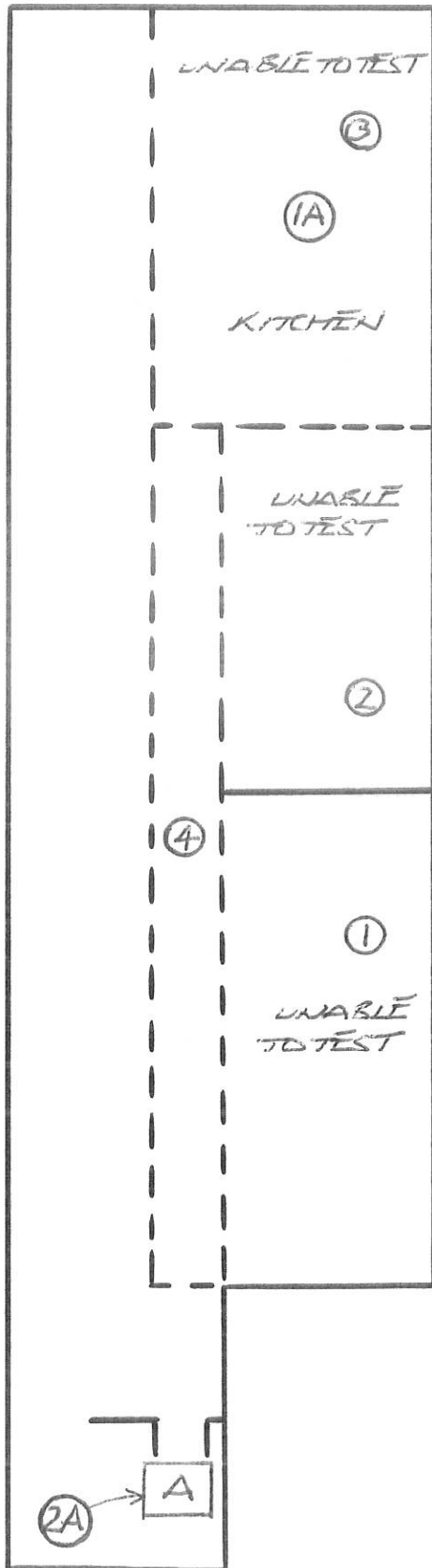

ENTRANCE

UNABLE TO TEST

③

①A

KITCHEN

UNABLE TO TEST

②

④

①

UNABLE TO TEST

②A

A

- ① PLASTERBOARD SET BACK 230mm FROM CEILING
- ② PLASTERBOARD SET BACK 220mm FROM CEILING
- ③ PLASTERBOARD SET BACK 250mm FROM CEILING
- ④ PLASTERBOARD SET BACK 210mm FROM CEILING

NOT TO SCALE



UK Analytical Ltd
Unit F1
Copley Hill Trading Estate
Whitehall Road
Leeds
LS12 1HE
Telephone: 0113 245 6303
Email: enquiries@ukanalytical.com
Web: www.ukanalytical.com

Report no: 22/22869

Date: 22 November 2022

Client: Adept Consulting Engineers Ltd.

Location: Rose Garden Café, Sheffield
Outbuilding to Rear
Concrete Testing

Appendix 2

Reinforcement Details

Roof Details

J M Noone BSc, Managing Director
R W Brown, Director

Registered Office: Endon House, 127 Barugh Lane, Barugh Green, Barnsley S75 1LJ
Registered in England. No: 9910400.
VAT Registered No: 230 3579 28

JOB No: 22869

ROSE GARDEN CAFE - SHEFFIELD

DATE: 15/11/22

REINFORCEMENT DETAILS - AREA A

DOOR

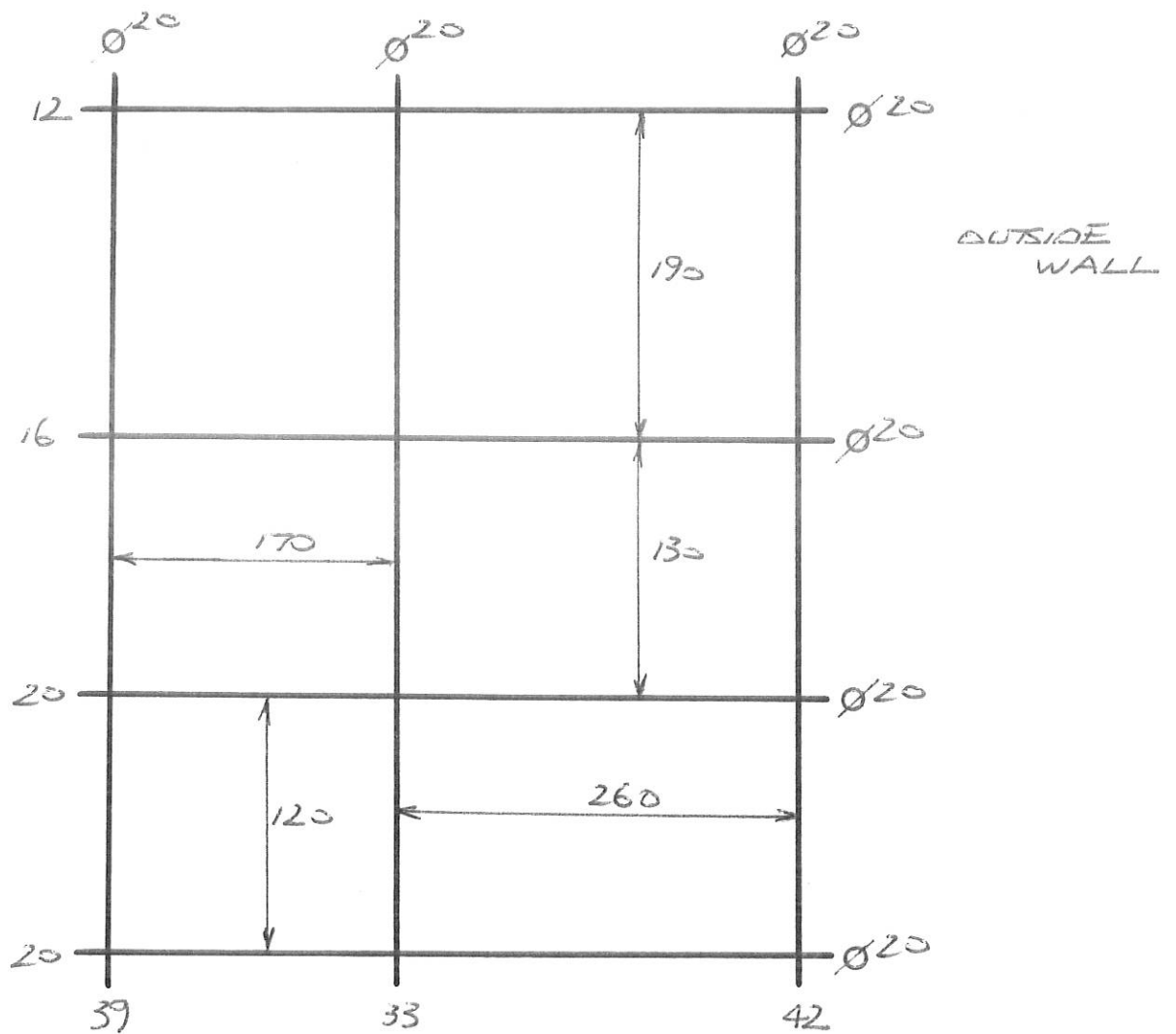

$\varnothing 20$

DIAMETER OF REINFORCEMENT mm

16

DEPTH OF COVER mm

ALL DIMENSIONS IN mm

NOT TO SCALE

JOB No: 22869

ROSE GARDEN CAFE - SHEFFIELD

DATE: 15/11/22

ROOF DETAIL

1A

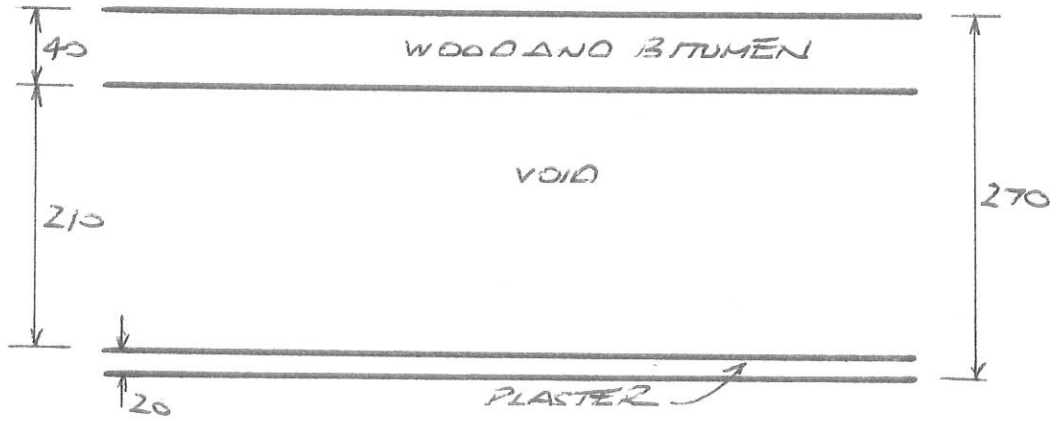

2A

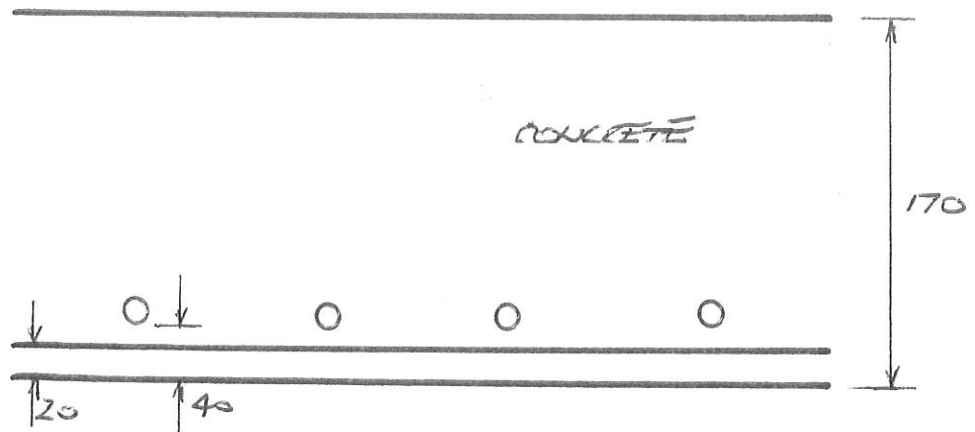

ALL DIMENSIONS IN MM

NOT TO SCALE



UK Analytical Ltd
Unit F1
Copley Hill Trading Estate
Whitehall Road
Leeds
LS12 1HE
Telephone: 0113 245 6303
Email: enquiries@ukanalytical.com
Web: www.ukanalytical.com

Report no: 22/22869

Date: 22 November 2022

Client: Adept Consulting Engineers Ltd.

Location: Rose Garden Café, Sheffield
Outbuilding to Rear
Concrete Testing

Appendix 3

Photographs

J M Noone BSc, Managing Director
R W Brown, Director

Registered Office: Endon House, 127 Barugh Lane, Barugh Green, Barnsley S75 1LJ
Registered in England. No: 9910400.
VAT Registered No: 230 3579 28

Report no: 22/22869

Date: 22 November 2022

Client: Adept Consulting Engineers Ltd.

Location: Rose Garden Café, Sheffield
Outbuilding to Rear
Concrete Testing

Location B Concrete Roof



J M Noone BSc, Managing Director
R W Brown, Director

Registered Office: Endon House, 127 Barugh Lane, Barugh Green, Barnsley S75 1LJ
Registered in England. No: 9910400.
VAT Registered No: 230 3579 28

Report no: 22/22869

Date: 22 November 2022

Client: Adept Consulting Engineers Ltd.

Location: Rose Garden Café, Sheffield
Outbuilding to Rear
Concrete Testing

Location A Kitchen



J M Noone BSc, Managing Director
R W Brown, Director

Registered Office: Endon House, 127 Barugh Lane, Barugh Green, Barnsley S75 1LJ
Registered in England. No: 9910400.
VAT Registered No: 230 3579 28

Report no: 22/22869

Date: 22 November 2022

Client: Adept Consulting Engineers Ltd.

Location: Rose Garden Café, Sheffield
Outbuilding to Rear
Concrete Testing

Larger Roof Area External



J M Noone BSc, Managing Director
R W Brown, Director

Registered Office: Endon House, 127 Barugh Lane, Barugh Green, Barnsley S75 1LJ
Registered in England. No: 9910400.
VAT Registered No: 230 3579 28

Report no: 22/22869

Date: 22 November 2022

Client: Adept Consulting Engineers Ltd.

Location: Rose Garden Café, Sheffield
Outbuilding to Rear
Concrete Testing

Smaller Concrete Roof Area External



J M Noone BSc, Managing Director
R W Brown, Director

Registered Office: Endon House, 127 Barugh Lane, Barugh Green, Barnsley S75 1LJ
Registered in England. No: 9910400.
VAT Registered No: 230 3579 28